

User Guide: Configure Exchange on Thunderbird for OS X (POP)



Note that POP configuration will download emails from MacMail inbox to your Thunderbird Inbox on your local computer and delete them from MacMail server after 14 days by default.

1. Open **Thunderbird**



2. Set **Thunderbird** as the **default** mail client

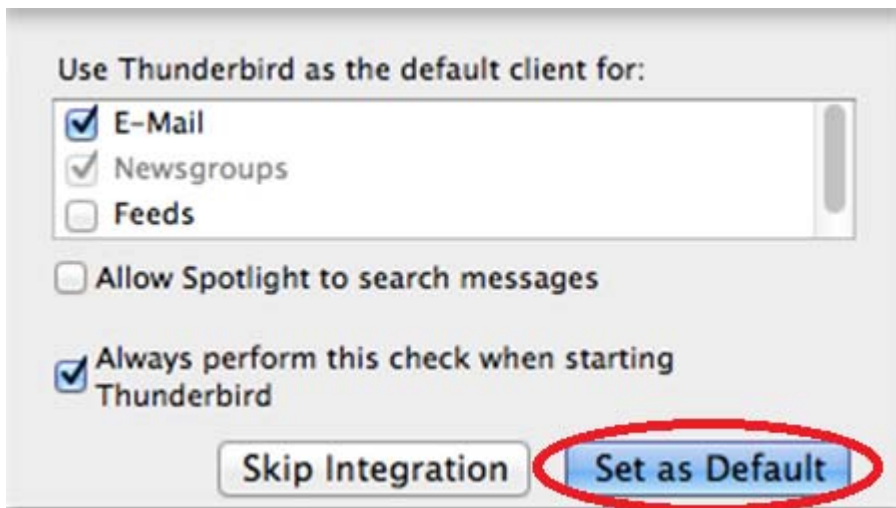

3. On the **Welcome Screen** click on **Skip this and use my existing email**

Would you like a new email address?

In partnership with several providers, Thunderbird can offer you a new email account. Just fill in your first and last name, or any other words you'd like, in the fields above to get started.

 gandi.net

The search terms used are sent to Mozilla ([Privacy Policy](#)) and to 3rd party email providers gandi.net ([Privacy Policy](#), [Terms of Service](#)) to find available email addresses.

4. Enter **Your name** at Your name:
5. Enter your macid@mcmaster.ca at Email address.
6. Enter your **MAC ID password** at Password.
7. Click on **Continue**

The image shows a standard macOS-style dialog box for account creation. It contains the following elements:

- Your name:** A text field containing "John Doe" with a placeholder "Your name, as shown to others" to its right.
- Email address:** A text field containing "tsdoe1j@mcmaster.ca".
- Password:** A text field containing eight dots, with a blue border around it.
- Remember password
- Buttons at the bottom: "Get a new account", "Cancel", and "Continue". The "Continue" button is circled in red.

9. Wait for the search to complete and fail

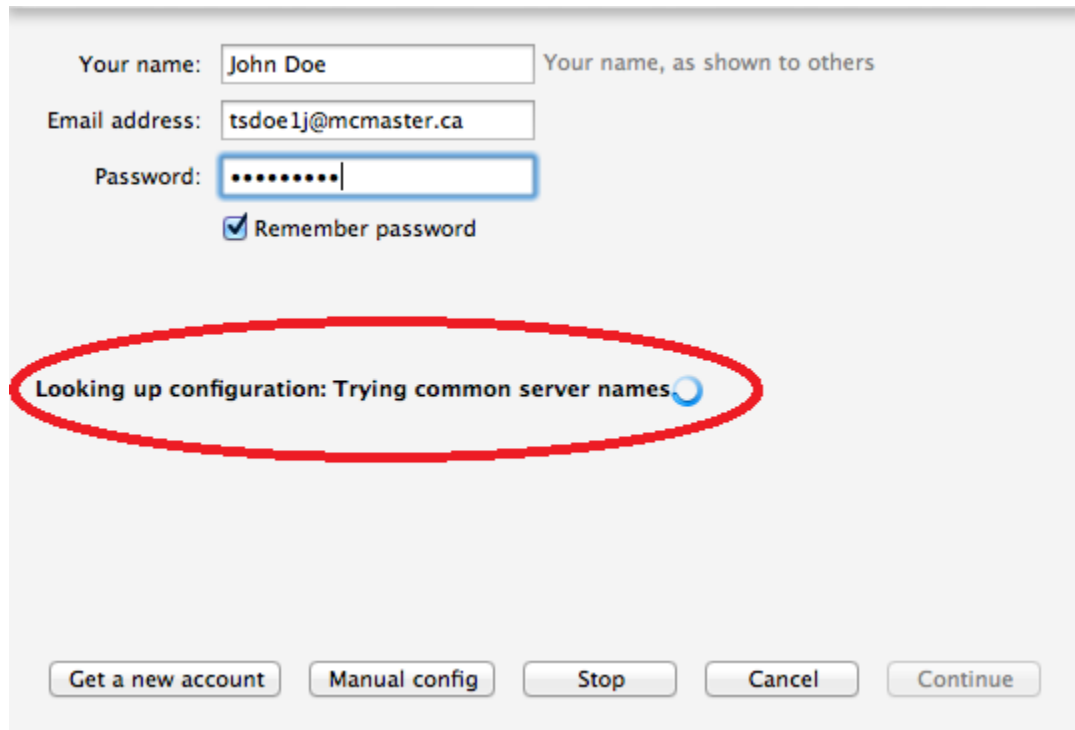

Your name: Your name, as shown to others

Email address:

Password:

Remember password

Looking up configuration: Trying common server names 

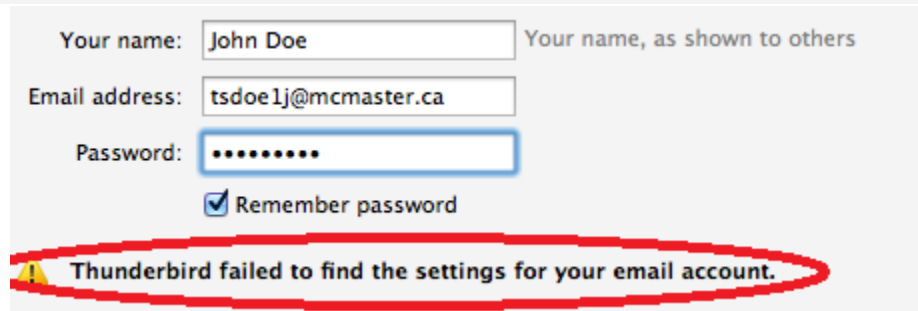

Your name: Your name, as shown to others

Email address:

Password:

Remember password

 **Thunderbird failed to find the settings for your email account.**

10. Under the **Server Hostname** for each **IMAP** and **SMTP** type in **FHSHC.CSU.MCMASTER.CA**
 - a. For **IMAP** select port **995**, and SSL select **SSL/TLS**
 - b. For **SMTP** select port **587**, and SSL select **STARTTLS**
 - c. Change the authentication for both **IMAP** and **SMTP** to **NTLM**
11. Click on **Done** to confirm the settings and save the account

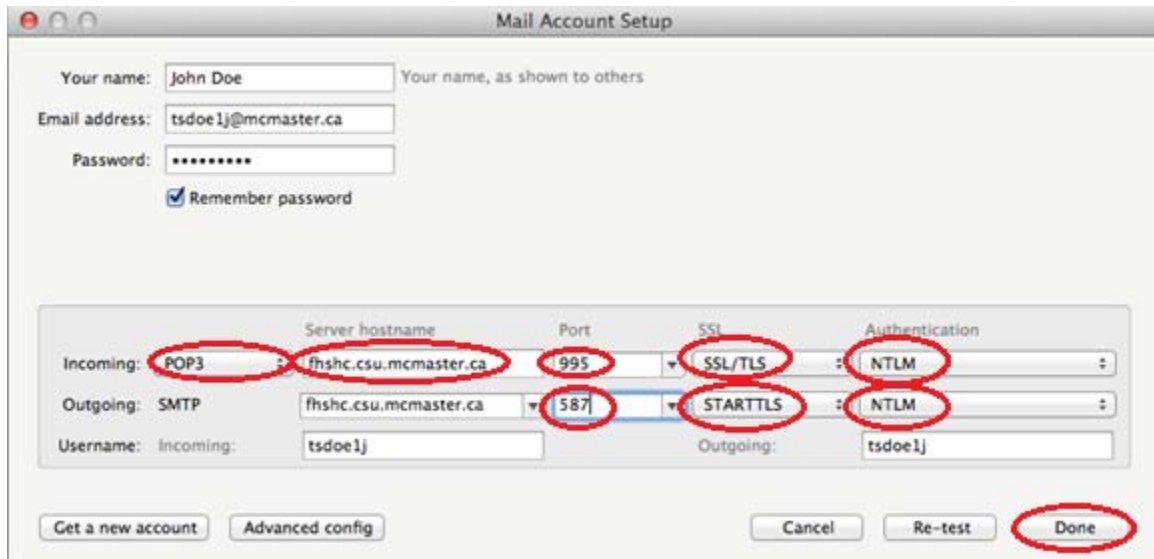

12. Click on the **Account Name** and click on **Get Messages**

